



Student Handbook

2023 - 2024

MISSION

The mission of the **Spartanburg Philharmonic Youth Orchestra** is to provide a rewarding experience for talented young musicians in the greater Spartanburg area who wish to expand their knowledge of symphonic literature, as well as participate in high-quality musical performances with professional, dynamic conductors.

CONTACT INFORMATION

Bob Borden

Youth Orchestra Operations Co-Manager
librarian@spartanburgphilharmonic.org

Susana Lalama, Ph.D.

Symphony Youth Orchestra Conductor
slalama@spartanburgphilharmonic.org

Helen Tipton

Youth Orchestra Operations Co-Manager
youthorchestra@spartanburgphilharmonic.org

Joshua Miller, Ph.D

Prelude Youth Orchestra Conductor
jmiller@spartanburgphilharmonic.org

Hannah Simpson

Education Manager, Spartanburg Philharmonic
hannah@spartanburgphilharmonic.org
864.948.9020

SpartanburgYouthOrchestra.org

SPARTANBURG PHILHARMONIC

200 East Saint John St. | Spartanburg, SC 29306

Table of Contents

Mission	1
Contact Information	1
Locations	3
Fees & Payment	4
Sponsorship	4
Musician Responsibilities	5
Musician Conduct	7
School Participation	8
Auditions	8
Concerto Competition	9
Media Policy	10
For the Parents	10
2023-2024 Calendar	12

Required Forms:

- Online Registration July 15
- Student Medical Information. Aug 1
- Musician Absence Form (see page 5)

Additional Forms:

- Sponsorship Form (see page 4). July 15
- Concerto Competition Audition Form (see page 9)

LOCATIONS

Mayfarth Rehearsal Hall: the Spartanburg Philharmonic Youth Orchestra rehearses in the Mayfarth Rehearsal Hall located on the lower floor of the Blackman Music Building at Converse University.

Parking is available in the lot off of Fairview Ave (#23 below). To enter the building, go through the breezeway of the Milliken Fine Arts Building (#22 below) and straight through the double glass doors into the upper lobby. Take the stairs located in the center of the upper lobby to the lower floor. Mayfarth will then be on the left of the lower lobby.

Twichell Auditorium: the Spartanburg Philharmonic Youth Orchestra performs in Twichell Auditorium at the Zimmerli Performance Center at Converse University. **Parking** is available in the lot off of Fairview Ave (#35 and #36 below). To get backstage, enter the Lawson Academy doors (#33 below) and proceed straight through the lobby. Follow the hallway left and then right to the backstage area.

Converse University

580 East Main St.
Spartanburg, SC 29302

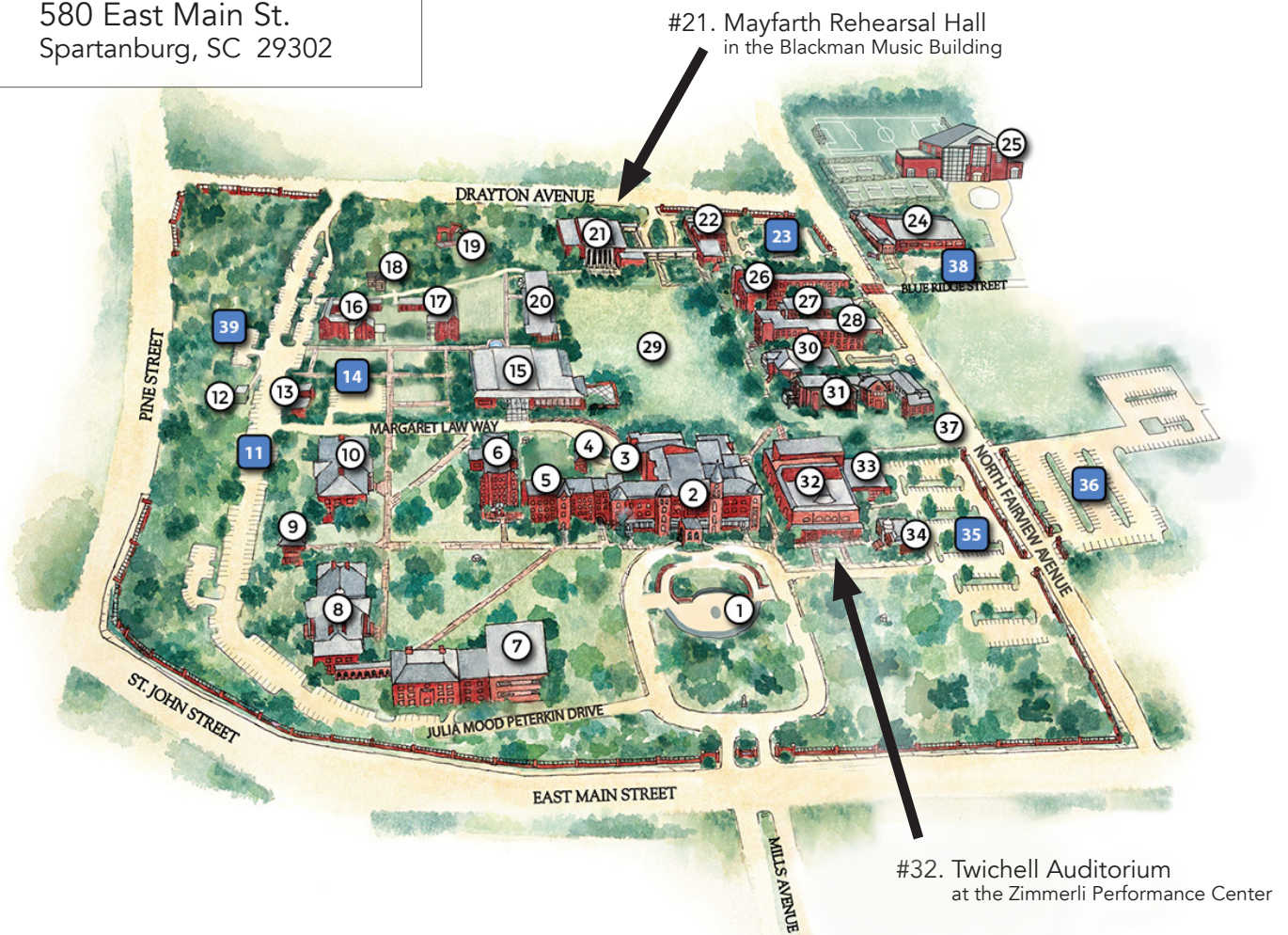

FEES & PAYMENT

Membership in the Spartanburg Philharmonic Youth Orchestra has a yearly tuition fee of \$250.00 for Prelude and \$275.00 for Symphony. At the beginning of the season, participants may pay in full or in three separate installments according to the schedule below.

\$25, Audition Registration

Symphony

- \$275, Full Tuition*
- **July 15, 2023** = \$100
First Tuition Installment*
- **September 1, 2023** = \$87.50
Second Tuition Installment
- **October 1, 2023** = \$87.50
Third Tuition Installment

Prelude

- \$250, Full Tuition*
- **July 15, 2023** = \$100
First Tuition Installment*
- **September 1, 2023** = \$75.00
Second Tuition Installment
- **October 1, 2023** = \$75.00
Third Tuition Installment

* Whether paying the Full tuition or the First Installment, it is **required** that all participants make the first payment on or by **July 15, 2023** in order to reserve their spot in the Youth Orchestra.

All Fees are Non-refundable

SPONSORSHIP

The Spartanburg Philharmonic Youth Orchestra has worked hard to establish and develop sponsorship funds to help qualified students participate. Sponsorship is a work-study-based award, and musicians receiving tuition assistance will be assigned tasks to perform throughout the season.

Details and forms for assistance are available on the Youth Orchestra portion of the Spartanburg Philharmonic website, and applications are due by **July 15, 2023**. All of the information is confidential and used only to determine eligibility for sponsorship. Sponsorship does not affect the standing that a musician has in the orchestra. Sponsorships do not carry over from year to year.

For additional information, please contact hannah@spartanburgphilharmonic.org.

MUSICIAN RESPONSIBILITIES

Attendance

An orchestra is a group effort; *every member is important* and contributes to the success of the ensemble, and so attendance is **required at all rehearsals and concerts**. If a student needs to miss a rehearsal, written communication must be received by the orchestra manager at least 24 hours in advance of the rehearsal (see below). The conductor reserves the right to re-chair students who have not attended all rehearsals. A list of approved absences include: personal illness; death in the immediate family; college visits (with advance notice); musical performances at school. The Youth Orchestra makes every attempt to avoid conflicts with school concert and state music education programs.

Reporting an Absence

It is the musician's responsibility to look over the season schedule and reconcile the concert dates with other activities. In the case that a musician is unable to attend a rehearsal, they must complete the **Absent Request Form** found on the Spartanburg Philharmonic Youth Orchestra web page and provide the following information:

- Name of musician
- Date of absence
- Orchestra instrument
- Reason for absence

SpartanburgYouthOrchestra.org/absence

Punctuality

All musicians must arrive **at least 15 minutes prior to the scheduled start of rehearsals**. Furthermore, musicians are considered tardy if they are not in their seats, tuned, and with their music on the stand by the beginning of rehearsal as well as after the break.

Where applicable, musicians should be picked up by a parent/guardian immediately following any Youth Orchestra event. *If a parent/guardian is unable to pick up a musician, please be considerate and arrange alternate transportation.*

Inclement Weather Cancellation

The decision to cancel any Spartanburg Philharmonic Youth Orchestra event will be made by 8:00 AM on the morning of the scheduled rehearsal or event, unless an emergency situation occurs. A communication will then be sent to everyone involved with cancellation information.

Preparation

Music is chosen to challenge and educate, and each musician is expected to prepare their music for each week's rehearsal. In an orchestra, it is essential for every member to know their parts well to play together. If a single musician does not know their part, the whole orchestra will not play or sound well together.

Music

All music for the Youth Orchestra performances will be provided free of charge. All musicians are responsible for their music folder and all of the music given throughout the season. It is the responsibility of each musician to bring all music to every rehearsal.

- If music is damaged or lost, please contact the Orchestra Manager at rehearsal or via email for a replacement part (see page 1).
- Please only use a #2 pencil to mark music.

Private Instruction

All musicians are encouraged to study with a private teacher and to work on Youth Orchestra music with their instructor. For more information or aid in finding an instructor, please contact the Youth Orchestra Staff for recommendations (see page 1).

Percussionists

Percussionists are expected to move, set-up, dismantle, and put away all percussion equipment for rehearsals *and* concerts. Percussionists should arrive **at least 30 minutes prior to the scheduled start of rehearsals** to set up the section, and they should plan to stay until all percussion equipment is put away. Percussionists should make arrangements with their transportation to and from rehearsals to allow for this extra time.

The equipment must be handled carefully, and all instruments must be returned exactly and neatly to their original storage areas.

Percussionists are required to supply all their own required mallets needed for each rehearsal.

Concert Attire

Both Symphony & Prelude:

All black formal pants, long skirts, long sleeved dress shirts, socks, and closed toe dress shoes. No white shirts.

NO white socks or tennis shoes.

Instrument Liability

All Youth Orchestra students/families are responsible for their instruments and all personal belongings brought to rehearsals or any Youth Orchestra sanctioned event. Lost, stolen or damaged instruments, instrument accessories, and all other personal items are not the responsibility of the Spartanburg Philharmonic Youth Orchestra. Musicians are encouraged to label their equipment in addition to having their instruments insured.

MUSICIAN CONDUCT

Musicians are ambassadors for the Spartanburg Philharmonic Youth Orchestra and thus are always expected to conduct themselves in a professional manner. The Youth Orchestra's supervisory responsibility for musicians extends only to the scheduled times of all events.

General Policies

Failure to comply with any Spartanburg Philharmonic Youth Orchestra policy may result in disciplinary action up to and including expulsion from the Youth Orchestra program and forfeiture of any tuition and fees paid.

- The Youth Orchestra strictly prohibits the use of alcohol, tobacco and drugs by any musician. Any musician found in violation will be immediately removed from the orchestra.
- Musicians must remain on the rehearsal premises from the time they arrive until they are picked up by their parents/guardians. Musicians who drive themselves must remain on the premises during the entire rehearsal.
- Musicians are expected to remain in specified areas at all times. The Youth Orchestra cannot assume responsibility for students leaving specified areas.
- At all times, musicians are expected to display common courtesy and respect to all Youth Orchestra staff, parent volunteers, and fellow musicians. Bullying, unruly behavior, physical/verbal assaults or any acts/words that show threat to harm or endanger the safety of others will not be tolerated. Foul language will not be tolerated.
- The Youth Orchestra is a guest of Converse University and must respect the space provided us. Musicians must leave the school in the same or better condition than it is found. Musicians must pick-up after themselves. Damage to or destruction of property is prohibited.
- In addition to having their instruments and their music in the proper folder, musicians should bring all proper accessories including mutes, rockstops, extra strings, reeds, percussion mallets, and a pencil with an eraser to all rehearsals/concerts. Musicians should not rely on their stand partner to provide any of these items.
- There will be no distracting communication or activity of any kind at any event. Cell phones shall be turned off, kept in case, and not used during rehearsals. Additionally, please see our social media policy on page 8.
- Food, drink, and gum are not allowed in the rehearsal or concert areas (bottled water with a cap is allowed).

Social Media Policy

Musicians are encouraged to use good judgment when using Social Media. They should avoid using statements, photographs, video, or audio that reasonably could be viewed as malicious, obscene, threatening or constitute harassment or bullying. Examples of such conduct might include offensive posts meant to intentionally harm someone's reputation or posts that could contribute to a hostile environment. Remember that online activities reflect both on an individual musician as well as the Youth Orchestra as a whole, whether these activities take place during or outside rehearsals.

SCHOOL PARTICIPATION

The Spartanburg Philharmonic Youth Orchestra believes that school music programs are vital to the development of young musicians – educationally, artistically and socially. By participating in school music programs, young musicians can serve as role models, receive leadership training and share their talents with others. Participation in the Spartanburg Philharmonic Youth Orchestra is designed to enhance, not replace, school music instruction. School music programs provide essential daily ensemble and rehearsal instruction required for serious musical progress.

Musicians who enroll in the Spartanburg Philharmonic Youth Orchestra are **expected** to participate in their school orchestra/band, if one exists.

AUDITIONS

Membership

Auditions to join the Spartanburg Philharmonic Youth Orchestra will be held each spring for participation in the following season. All current musicians wishing to continue with the Youth Orchestra must audition each year.

Seating/Rotation

Within the first few weeks of each concert cycle, string chair auditions will be held. Please note the following stipulations:

- Students may be auditioned on ALL of the concert music.
- Seating for every section in the orchestra can be rotated (either by concert or by individual pieces on the concert) at the conductor's discretion.

Auditions: Seating/Rotation continued

Factors that are considered in determining seating/rotation include:

- Musical needs of the entire ensemble (what will make us sound best)
- Technical requirements of each piece
- Experience as a player
- Consistency of performance at rehearsals and concerts
- Equitable distribution of opportunities
- Seniority
- Attendance
- Leadership skills
- Auditions
- Consistent level of preparedness
- Sectional seating is always at the discretion of the conductor. The conductor makes all final decisions on matters related to seating.

CONCERTO COMPETITION

The Concerto Competition is held annually in the fall and is open only to members of the Symphony Ensemble in the Youth Orchestra. The Concerto Competition is used to select soloists to perform with the Youth Orchestra at the scheduled spring concert.

- The Concerto Competition audition **registration fee is \$20**.
- The Youth Orchestra **conductor must approve repertoire before a musician may register to audition**. The conductor will review the repertoire for suitability of performance by the orchestra and for the availability of the orchestral parts.
- To register for the Competition, Musicians must **register online by Sunday, Sept. 24, 2023**.
- Participants must perform a single-movement piece or a movement of a standard concerto for their instrument.
- Multiple winners may be announced, and all will perform with the Youth Orchestra on a concert.
- Previous winners cannot perform as soloists with the Youth Orchestra in consecutive years.
- If chosen to perform with the orchestra, the winner(s) will write program notes for the piece and provide their biography.
- The Concerto Competition is judged by personnel from the Spartanburg Philharmonic.

MEDIA POLICY

Throughout the season, the Spartanburg Philharmonic Youth Orchestra will take photos and video recordings during rehearsals and performances to showcase the ensemble. The pictures and videos will be used for promotional purposes in the near future and will include social media and print publications. Photos and videos will **portray positive experiences and the joy of music making** in the Youth Orchestra. Parents/guardians will be given the option to approve/disapprove during the registration process after a musician is accepted into the program.

FOR THE PARENTS

Youth Orchestra Concert Tickets

As a matter of policy, the Spartanburg Philharmonic Youth Orchestra does not issue complimentary tickets to our Musicians. Revenue from ticket sales is an important source of funds, helping the organization offset concert hall rental costs. Accordingly, all concert patrons need to purchase tickets online or at the Twichell Auditorium box office.

Individual concert tickets are **\$10 for Adults** and **\$5 for Students**.

*Help support the Spartanburg Philharmonic Youth Orchestra and their outstanding musicians!
Come to all concerts and bring a friend, neighbor, or relative!*

Donor Support

The Spartanburg Philharmonic uses individual donations, foundation grants, and concert ticket sales to keep Youth Orchestra Membership Fees as low as possible, striving to allow every qualified student to take part. Families of Youth Orchestra Musicians are encouraged to make a tax-deductible donation to the Spartanburg Philharmonic Youth Orchestra during its annual giving campaign – or at any time during the season – to help reach their goal.

Donors may designate their support for a specific student (Individual Sponsorship) or for a specific fund (General Expenses, Concerts, Concerto Competition, etc.).

The Spartanburg Philharmonic

Youth Orchestra Musicians are strongly encouraged to attend the Spartanburg Philharmonic concerts at both Twichell Auditorium and the Chapman Cultural Center. It is a great way to experience high-quality music performed live! The Spartanburg Philharmonic offers a special **50% Discount** to all youth under age 22. Visit us online for more information:

SpartanburgPhilharmonic.org/events

2023-2024 Season:

ZIMMERLI SERIES

Twichell Auditorium
@ 7:00 PM

Sept. 16, 2023

Dvorak: From the New World

Dec. 8-10, 2023

The Nutcracker
PRESENTED WITH **Ballet Spartanburg**

Feb. 17, 2024

Beethoven: Symphony no. 4

Mar. 23, 2024

Best of Broadway
PRESENTED WITH **Spartanburg Little Theatre**

Apr. 20, 2024

Shostakovich: Symphony no. 5

ESPRESSO SERIES

Chapman Cultural Center
@ 6:30 PM

Sept. 29, 2023

Espresso Serioso
String Quartet & Harp

Nov. 17, 2023

Jazz Jolt
Project Trio

Jan. 26, 2024

Cafe Celestial
Woodwind Quintet

Mar. 15, 2024

Dark Roast Dance
Classical and Contemporary Pieces

2023-2024 CALENDAR

2023

Jul. 15	TUITION PAYMENT #1 DUE		
Aug. 6	SPYO: Poppin' Pop In	2:00-4:00 pm	
		SYMPHONY	PRELUDE
Aug. 13	Rehearsal #1	1:30-3:30 pm	4:00-5:30 pm
Aug. 20	Rehearsal #2	1:30-3:30 pm	4:00-5:30 pm
Aug. 27	Rehearsal #3	1:30-3:30 pm	4:00-5:30 pm
Sept. 1	TUITION PAYMENT # 2 DUE		
	— No Rehearsal on Sept. 3 —		
Sept. 10	Rehearsal #4	1:30-3:30 pm	4:00-5:30 pm
Sept. 17	Rehearsal #5	1:30-3:30 pm	4:00-5:30 pm
Sept. 24	Rehearsal #6	1:30-3:30 pm	4:00-5:30 pm
	CONCERTO COMPETITION REGISTRATION DUE		
Oct. 1	FINAL TUITION PAYMENT # 3 DUE		
Oct. 1	Rehearsal #7	1:30-3:30 pm	4:00-5:30 pm
	— No Rehearsal on Oct. 8 —		
Oct. 15	Rehearsal #8	1:30-3:30 pm	4:00-5:30 pm
Oct. 22	Rehearsal #9	1:30-3:30 pm	4:00-5:30 pm
Oct. 29	Rehearsal & CONCERT @ 3:00 PM Twichell Auditorium		
Nov. 5	CONCERTO AUDITIONS	1:30-3:30 pm	4:00-5:30 pm
	— No Rehearsal on Nov. 5 —		
Nov. 12	Rehearsal #1	1:30-3:30 pm	4:00-5:30 pm
Nov. 19	Rehearsal #2	1:30-3:30 pm	4:00-5:30 pm
	— No Rehearsal on Nov. 26 —		
Dec. 3	Rehearsal #3	1:30-3:30 pm	4:00-5:30 pm
Dec. 10	Rehearsal #4	1:30-3:30 pm	4:00-5:30 pm

2024

Jan. 7	Rehearsal #5	1:30-3:30 pm	4:00-5:30 pm
Jan. 14	Rehearsal #6	1:30-3:30 pm	4:00-5:30 pm
Jan. 21	Rehearsal #7	1:30-3:30 pm	4:00-5:30 pm
Jan. 28	Rehearsal #8	1:30-3:30 pm	4:00-5:30 pm
Feb. 4	Rehearsal & CONCERT @ 3:00 PM Twichell Auditorium		
Feb. 11	Rehearsal #1	1:30-3:30 pm	4:00-5:30 pm
	— No Rehearsal on Feb. 18 —		
Feb. 25	Rehearsal #2	1:30-3:30 pm	4:00-5:30 pm
Mar. 3	Rehearsal #3	1:30-3:30 pm	4:00-5:30 pm
Mar. 10	Rehearsal #4	1:30-3:30 pm	4:00-5:30 pm
Mar. 17	Rehearsal #5	1:30-3:30 pm	4:00-5:30 pm
Mar. 24	Rehearsal #6	1:30-3:30 pm	4:00-5:30 pm
	— No Rehearsal on March 31st —		
Apr. 7	Rehearsal #7	1:30-3:30 pm	4:00-5:30 pm
Apr. 14	Rehearsal #8	1:30-3:30 pm	4:00-5:30 pm
Apr. 21	Rehearsal & CONCERT @ 3:00 PM Twichell Auditorium		